

PRODUCT DATA SHEET

PRODUCT CODE
BR_WCF114X59R

RANGE
Toilet Cisterns

DESCRIPTION
Slim Depth WC Support Frame 1.14M Height (with dual flush concealed cistern & installation kit)



CATEGORY	Sanitaryware
WARRANTY DETAILS	5 Years
PRIMARY MATERIAL	Steel
SECONDARY MATERIAL	Plastic
INSTALL TYPE	Floor Standing
PRODUCT WIDTH MM	590
PRODUCT HEIGHT MM	1140
PRODUCT LENGTH MM	110
PRODUCT NET WEIGHT KG	16.61
STANDARDS	BS EN 14055:2018

FIXINGS INCLUDED	Yes
FLUSH VOLUME	6/3L
FIXING TYPE	Floor fixing
CISTERN FLUSH MECHANISM	Dual Flush with Mechanical Flush Plate
NOISE CLASS	Group I

TECHNICAL DIMENSIONS

Dimensions in mm unless otherwise specified.

Tolerances (per material type) apply.

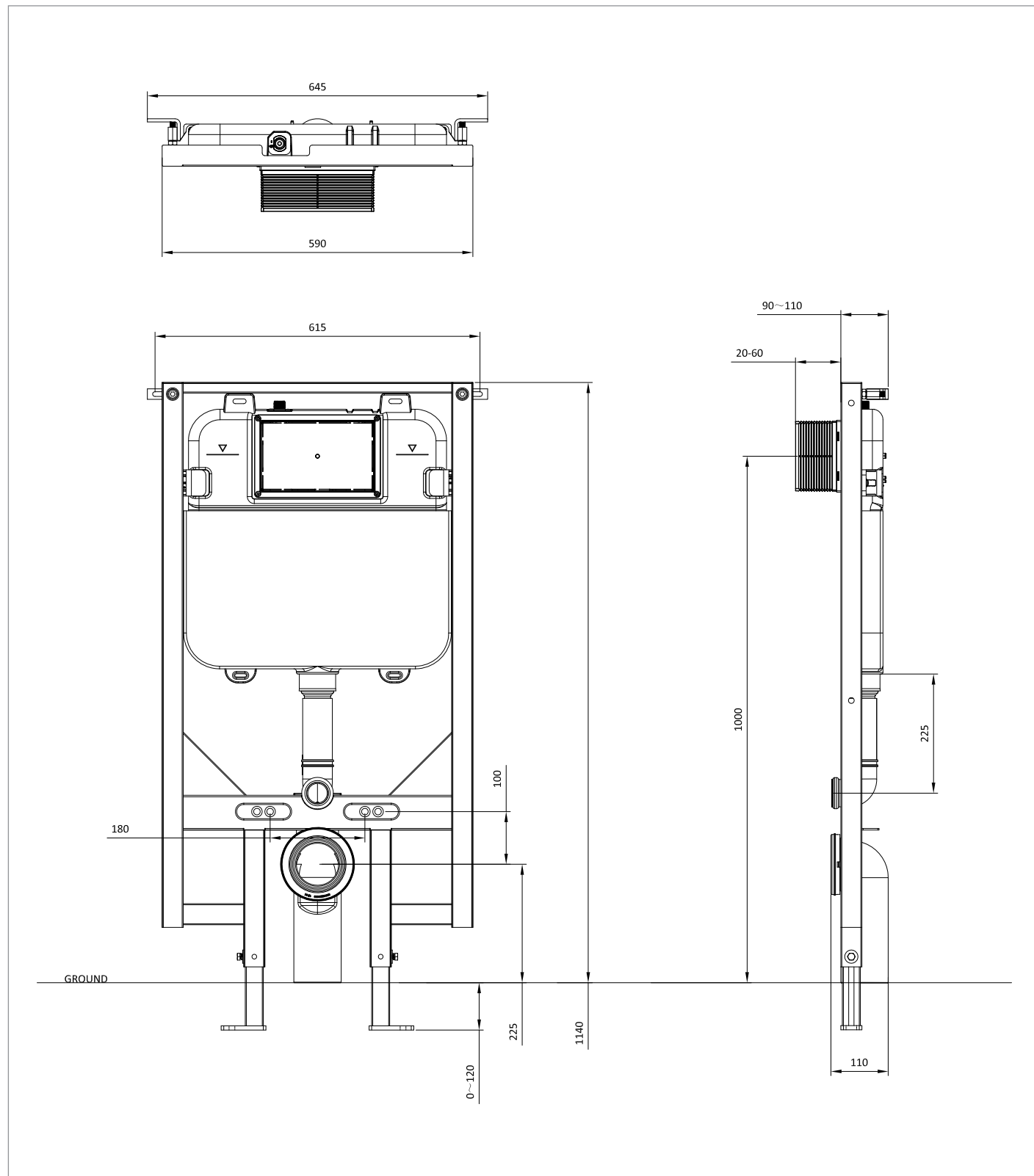

SPARES LIST

Only the parts labelled are available as spares.

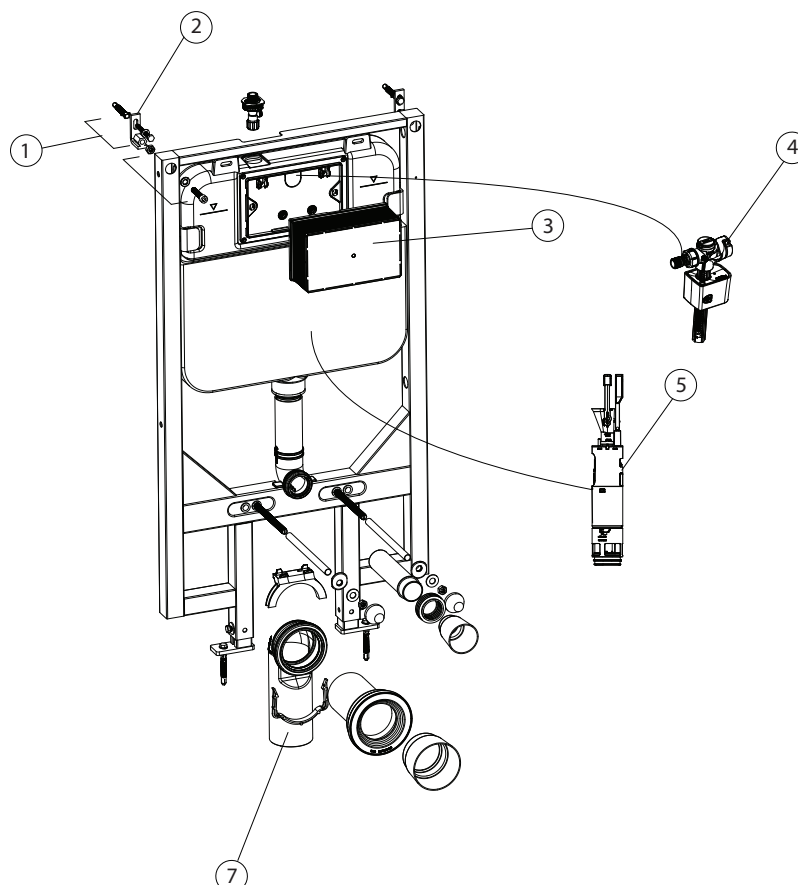

NUMBER	PART CODE	DESCRIPTION
1	CWSP003	Replacement fixing bracket for WCF114X59R
2	CWSP004	Replacement expansion bolt for concealed frames
3	CWSP010	Flush plate mounting assembly for WCC51X51R/WCF114X59R
4	CWSP023	Replacement fill valve for WCC51X51R / WCF114X59R
5	CWSP026	Replacement flush valve for WCC51X51R / WCF114X59R
6	CWSP027	Replacement flush rod for concealed cisterns and frames
7	CWSP028	Replacement waste pipe for concealed frames