

PRODUCT DATA SHEET

BRITTON®

PRODUCT CODE  
BSW0290M

RANGE  
Hoxton 2.0

DESCRIPTION  
Universal Standard Click Clack Basin  
Waste Matt Black



CATEGORY	Brassware
WARRANTY DETAILS	2 Years
COLOUR	Matt Black
FINISH APPLICATION	Immersion Plating
PRIMARY MATERIAL	Brass
INSTALL TYPE	Basin Mounted
PRODUCT WIDTH MM	61
PRODUCT HEIGHT MM	145
PRODUCT DEPTH MM	61
PRODUCT NET WEIGHT KG	0.37

SWIVEL SPOUT	No
OUTLET CONNECTIONS THREAD	1 1/4"
WASTE INCLUDED	Yes
ANTI-SCALD	No
ENERGY SAVING	No
SHOWER HOSE & HANDSET ARE INCLUDED	No

PRESSURE (BAR)	0.2	0.5	1	2	3	4	5
PRIMARY FLOWRATE							
HANDSET FLOWRATE							
MASSAGE FLOW RATE							
AIR FLOW RATE							
WIRE FLOW RATE							
WATERFALL FLOW RATE							
MIST FLOW RATE							
HANDSPRAY FLOW RATE							

 Part of the Bathroom Brands Group

## TECHNICAL DIMENSIONS

Dimensions in mm unless otherwise specified.

Tolerances (per material type) apply.

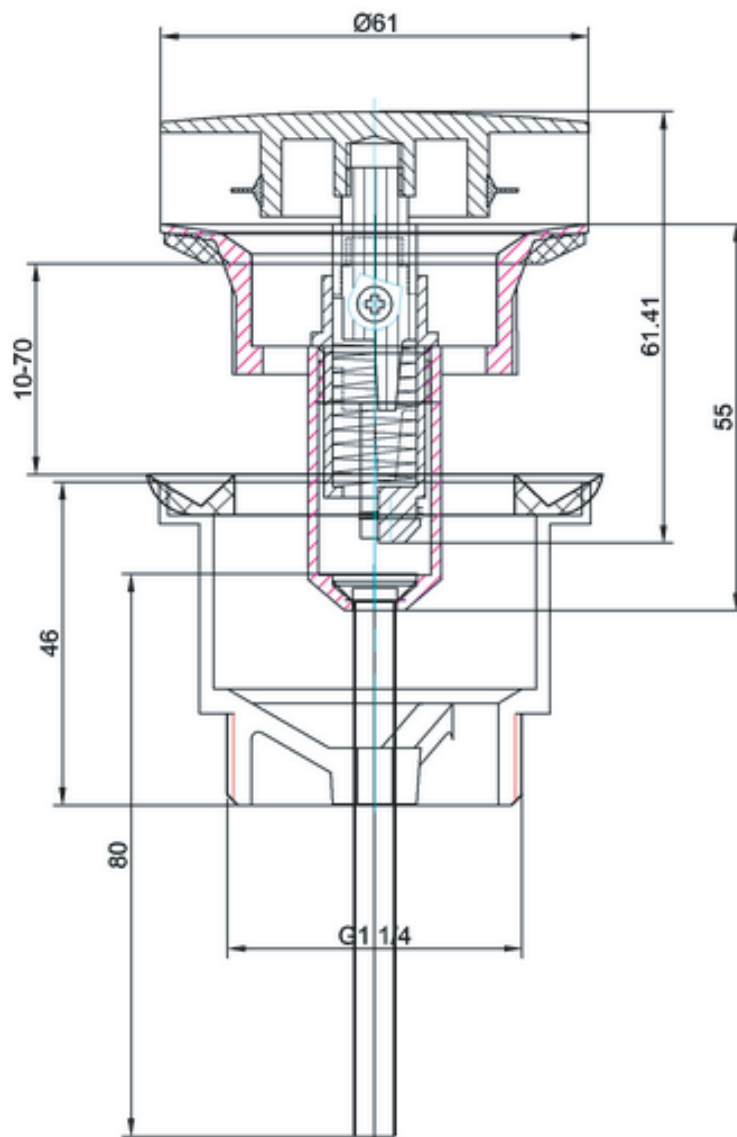

## SPARES LIST

Only the parts labelled are available as spares.

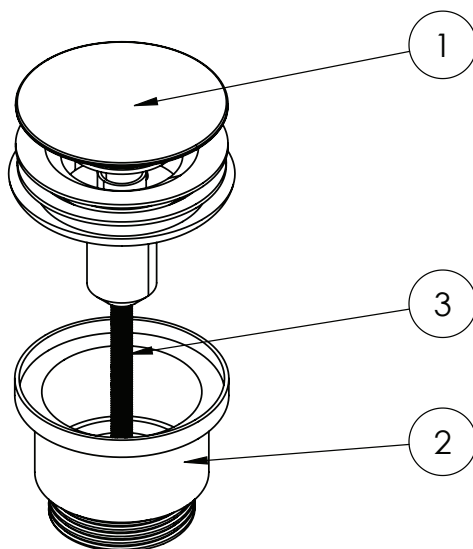

NUMBER	PART CODE	DESCRIPTION
1	SP1910M	Waste cover in matt black finish for BSW0290M
	SP1910F	Waste cover in brushed brass finish for BSW0290F
	SP1910C	Waste cover in chrome finish for BSW0290C
2	SP1911M	Fixing nut in matt black finish for BSW0290M
	SP1911F	Fixing nut in brushed brass finish for BSW0290F
	SP1911C	Fixing nut in chrome finish for BSW0290C
3	SP1912	Fixing screw for BSW0290 all finishes